



# MINILED DO

INSTALLATION TYPE:  
CEILING RECESSED





| MINILED 4247R | MINILED ROUND 4248R     | MINILED QUADRO 4249R    | MINILED SQUARE 4250R    | MINILED DOR 4248S     | MINILED DOQ 4249S     |
|---------------|-------------------------|-------------------------|-------------------------|-----------------------|-----------------------|
| LED MAX 11W   | LED MAX 11W             | LED MAX 11W             | LED MAX 11W             | LED MAX 2x8,5W        | LED MAX 2x8,5W        |
| CL            |                         |                         |                         |                       |                       |
| DC / AC       | DC MAX 900mA C.C. 11,5V | DC MAX 900mA C.C. 11,5V | DC MAX 900mA C.C. 11,5V | DC MAX 700mA C.C. 23V | DC MAX 700mA C.C. 23V |
| IP            | IP44 / IP20             | IP44 / IP20             | IP44 / IP20             | IP44 / IP20           | IP44 / IP20           |
| Lb            | 1.10                    | 1.10                    | 1.10                    | 1.76                  | 1.76                  |

| MINILED COLLI 4254A | MINILED MONTI 4254B     | MINILED CILLI 4254C     | MINILED DIAGO 4247Z     | MICROLED 4247G        | MICROLED ROUND 4248G  |
|---------------------|-------------------------|-------------------------|-------------------------|-----------------------|-----------------------|
| LED MAX 11W         | LED MAX 11W             | LED MAX 11W             | LED MAX 11W             | LED MAX 4W            | LED MAX 4W            |
| CL                  |                         |                         |                         |                       |                       |
| DC / AC             | DC MAX 900mA C.C. 11,5V | DC MAX 900mA C.C. 11,5V | DC MAX 900mA C.C. 11,5V | DC MAX 1400mA C.C. 3V | DC MAX 1400mA C.C. 3V |
| IP                  | IP44 / IP20             | IP44 / IP20             | IP44 / IP20             | IP44 / IP20           | IP44 / IP20           |
| Lb                  | 0.99                    | 1.01                    | 0.97                    | 0.51                  | 0.51                  |

x1 - 4247R/4248R/4249R/4250R  
4254A/4254B/4254C/4247Z  
4247G/4248G  
x2 - 4248S/4249S

| * ART.  |              |        |
|---|--------------|--------|
| 4247R / 4248R / 4249R<br>4250R / 4254A / 4254B<br>4254C / 4247Z | 12.0x12.0 cm | 3.0 cm |
| 4248S / 4249S   | 12.0x20.0 cm | 3.0 cm |
| 4247G / 4248G   | 9.5x9.5 cm   | 3.0 cm |

Remote Driver  
NOT Included

**ALWAYS REMOVE THE BLACK PROTECTION BEFORE SWITCHING ON THE SPOTLIGHT.**

**OFF**

**OFF**

THE DRIVER MUST BE TURNED OFF.  
WAIT AT LEAST 20 MINUTES AFTER TURNING IT  
OFF BEFORE MAKING THE ELECTRICAL CONNECTION.

REMOVE THE PROTECTION

**ON-OFF/DIM TEST**

\*DO NOT TURN ON WITH  
PAINT COVER ON

**OFF ON**

**4247R-4248R-4249R-4250R-4254A  
4254B-4254C-4247Z-4247G-4248G**

AFTER SWITCHING OFF THE SPOTLIGHT  
REPOSITION THE PROTECTION

X2  
TEKS POINT SELF DRILLING SCREW  
Ø 0.35

**4248S-4249S**

AFTER SWITCHING OFF THE SPOTLIGHT  
REPOSITION THE PROTECTION

X2  
TEKS POINT SELF DRILLING SCREW  
Ø 0.35

REMOVE THE PROTECTION

sales@gordonbullard.com  
www.byiba.com  
1 877-964-4646



991 South Gull Lake Dr.  
Richland, MI 49083  
USA

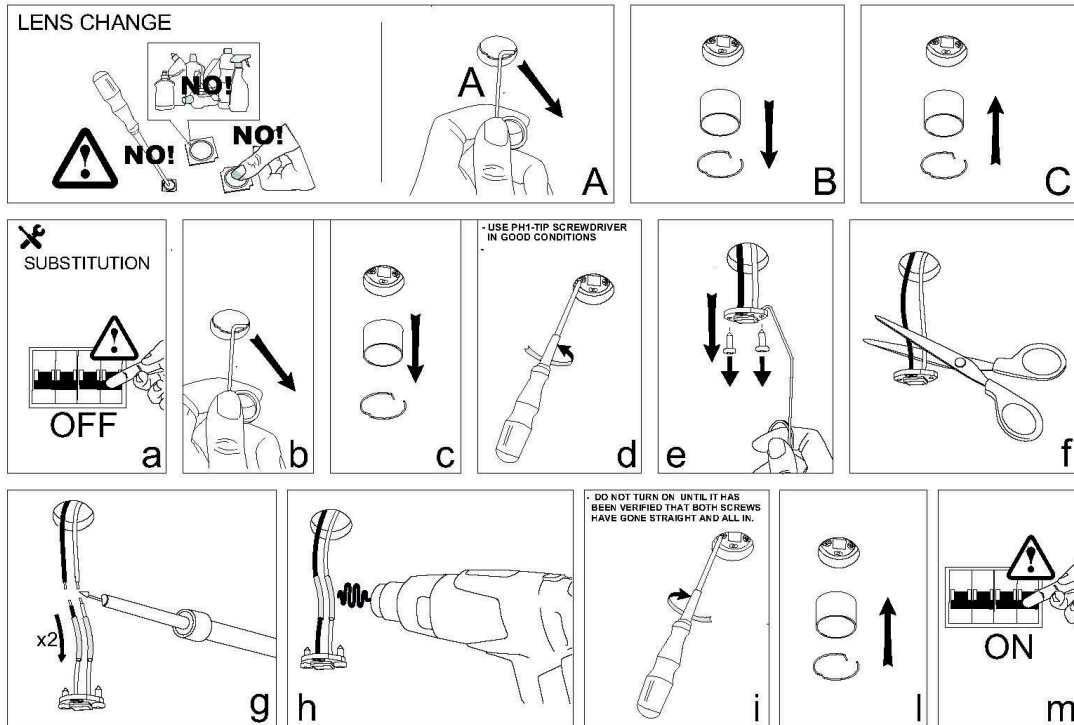



**IMPORTANT**

To ensure equipment safety you must carefully follow the instructions below. This leaflet must be kept handy by personnel entrusted with all ordinary and extraordinary maintenance.

- Before any installation or maintenance operation on the bulb, make sure it is disconnected from power
- Fit the correct bulbs, according to the type and power indicated on the lamp data label.
- Make sure the lamp technical features are compatible with the use you are going to make of it.
- Should you have any doubt, refer to the dealer or ask an electrician.
- When connecting to the mains, follow the correct colour code for power cables: (N) blue, (L) brown or black and, only for class I equipment, (T) yellow/green.
- When lamps are to be fitted to the wall directly through their ceramic parts, fasten the fixing screws lightly, to avoid breaking the ceramic.
- To clean the lamp on the outside, use a soft cloth, possibly wet. Do not use solvents or abrasive products. No liquid must get in contact with the lamp interior parts.
- Do not touch the equipment with dirty hands.



= Class I equipment, must be connected to an earth terminal.



= Double insulated lamp, does not need earthing.



= Electrical equipment in class III, electrical safety guaranteed by low voltage tension, does not require grounding



= Minimum distance to be observed from all lit up objects.



= Replace immediately the safety glass, if damaged, with the original part.



= The lamp uses low pressure bulbs, and needs no protection glass.



= The equipment at the end of its life must be collected separately from other waste.