

INSTRUCTION SHEET

NORKA – KIRA – KART – NIMO – IORIA – KAEL – NARON - KION

False-ceiling

1. Make a hole with a milling cutter D.54mm.
2. For the wiring follow nota 1.
3. Flex the spring and put the spot in to the hole. **Warning**
4. For remove the spot, extract it from the hole.

L

The recessed part of the product must be with direct contact with the air. Any obstacle can be reduce the lifetime of the product.

1
Ø 54mm(2.12"):

3

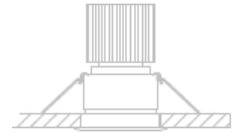
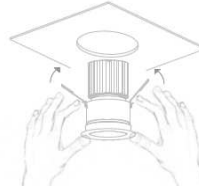

1:

- The products NORKA, KART, IORIA, KAEL must be powered at 500mA. Wiring in series, the red wire is positive and the black wire is negative.
- The products KIRA, NIMO must be powered at 350mA. Wiring in series, the red wire is positive and the black wire is negative.

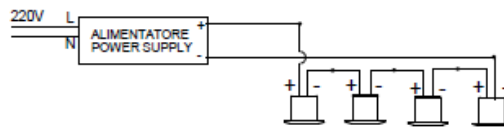

- Must be used the cable with minimum section of 0.5mm², must be use not over 30m of cable at the secondary of driver.

The product installation and electrical connection must be made by qualified operator, M & M luce declines any liability for damage caused by improper installation.

It is important that all operations are carried out in the absence of 220Vac, can be restored at the end of all wiring and connected to the secondary of the respective power supplies, the inobservance of this rule can lead to equipment failure.

Any changes to the product, inappropriate use and the not observance to the instruction will make decay the warranty.

This warranty is limited, not included any damage due to natural causes such as fire, lightning or flooding.

Commercial and technical reports related to the warranty are only between M&M luce and our direct customers.

The warranty of the M&M luce's products is for 24 month from the date of purchase.