

DIVINA SQUARE(SUSPENDED) USER MANUAL

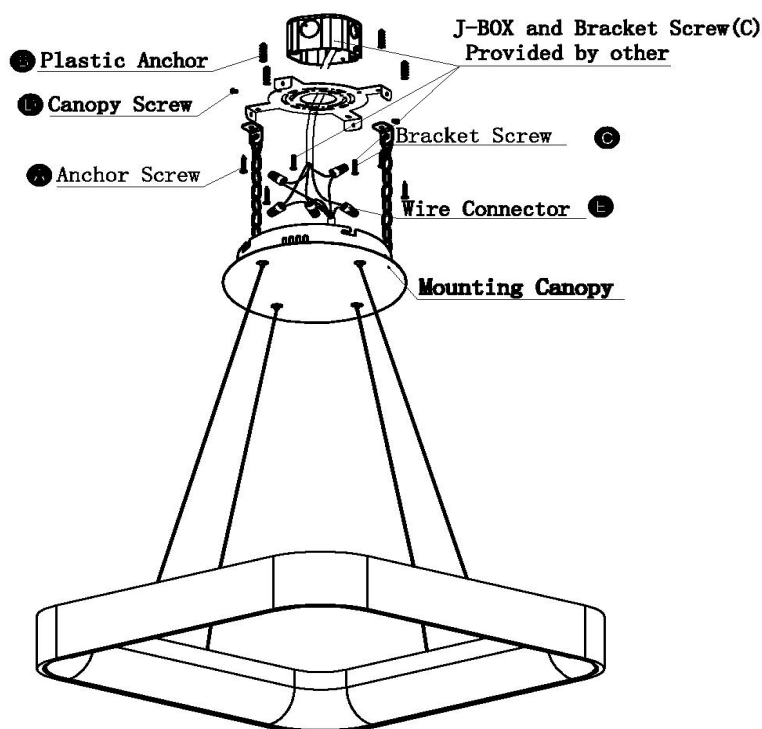

Please read this installation manual carefully before installation, keep it for future reference! Products are well packed and performing well before leave our factory. Please strictly follow the instructions listed in the manual. Factory or distributor shall not be hold responsible for any mis-operation or damage caused by not following up the manual!

Installation Diagram



Step 1

Shut "OFF" the electricity at main fuse box.

Place the wall switch in the "OFF" position.

Tools You May Need

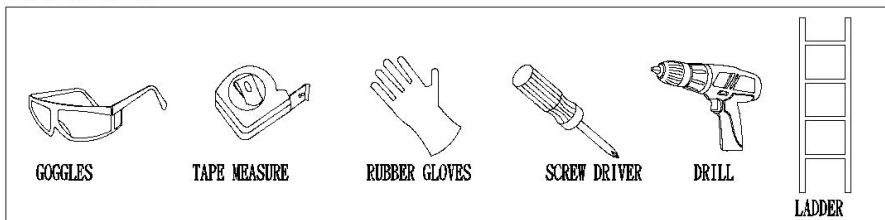

Circuit Box

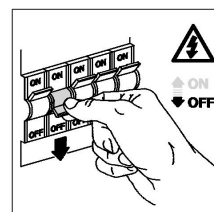

Step2

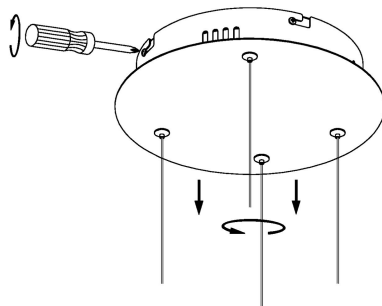

Step3

Take out Plastic Anchor, drill 4 pcs or 6 pcs diameter 6mm holes on the ceiling according to Mounting Bracket.
(note: the fixture is bigger than 2ft*2ft (including 2ft*2ft), need 6pcs holes, 4 for Bracket screw, 2 for safety Bracket screw). Insert the plastic anchors into the holes. (Use 2 pcs M4*25mm Screws to fix Mounting Bracket with J-Box, refer to picture shown below.

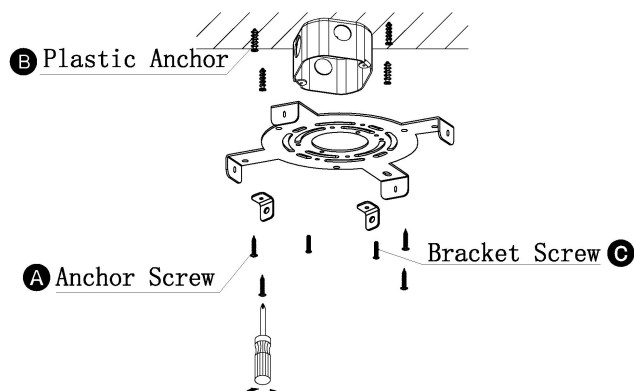

Step4

Use 4pcs M4*25 Self-Tapping screw to fix Mounting Bracket on the ceiling.

NOTE: J-BOX by Garvin 54171-S or equivalent / Provided by others

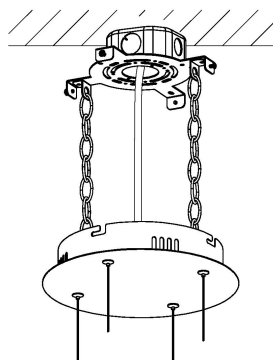

Attention: Must secure mounting plate at all connection points (junction box plus four outer points for small and medium size, or six outer points for large size) to support fixture weight appropriately. Not using all mounting points could damage the fixture and void product warranty.

Step 5

Use wire connectors to connect L,N,G,DIM+,DIM- wires. After finish, Put all Wires with connector into J-Box

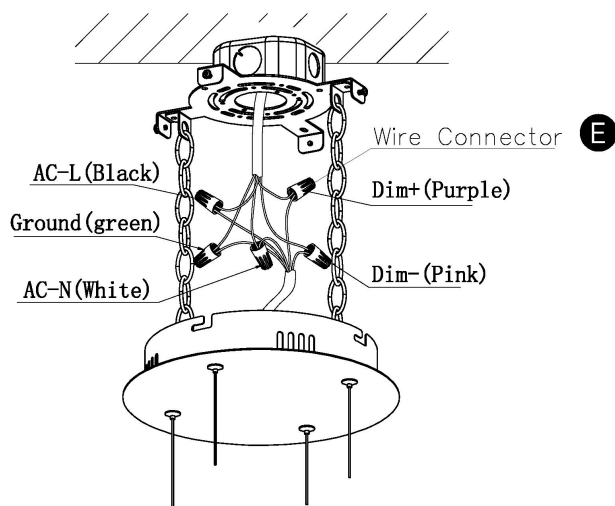

Step 6

Use screw driver to adjust Mounting Bracket and Canopy. Have the Slot hole vertical to Side screw, and push screw into slot, rotate lamp body to fix it.

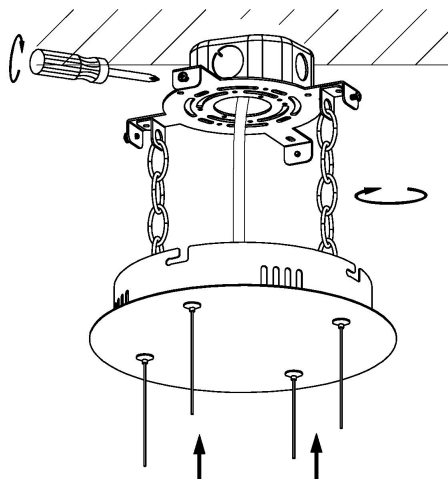

Step 7

Adjust the safety chain and aircraft cable length, use screw to fix with mounting bracket and canopy, then loosen all the cables.

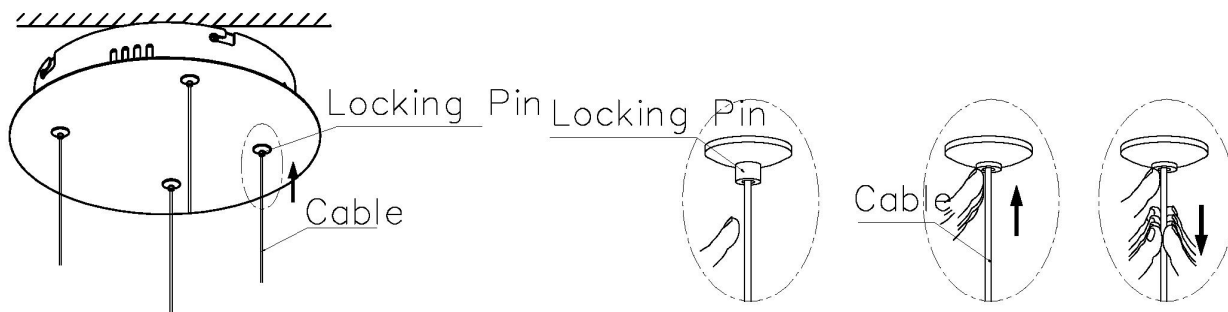

Step 8

Turn on the electricity at main fuse box, the lighting works.

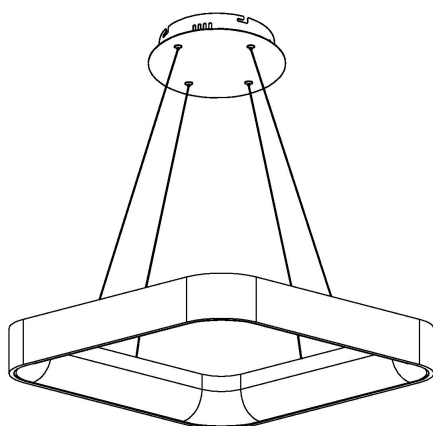

Circuit Box

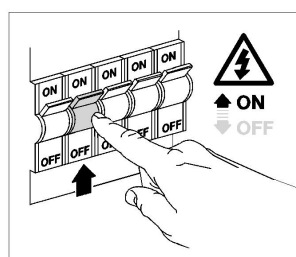

Warnings

- MIN 90 °C SUPPLY CONDUCTORS
- DAMP LOCATIONS ONLY
- CAUTION – RISK OF FIRE

THIS PRODUCT MUST BE INSTALLED IN ACCORDANCE WITH THE APPLICABLE INSTALLATION CODE BY A PERSON FAMILIAR WITH THE CONSTRUCTION AND OPERATION OF THE PRODUCT AND THE HAZARDS INVOLVED

- Application temperature for ring light is -20°C~40°C , humidity is 0~95 % . Otherwise there may be harm to the lifespan of the light.
- Please TURN OFF POWER before installation. This lamp must be installed and maintained by electrician or qualified personnel.
- Pay attention to fire prevention, electricity and shock resistance.
- Please do not cover the combustibles on the fixture.
- All screws and terminals should be tightened and tightly inserted. No loosening and improper connection are allowed. Attention should be paid to the polarity of components, power supply, driver and so on.
- Terminals should be tightened and tightly inserted. No loosening and improper