

CATEGORY:

Indoor, Suspension or Surface Mount, Damp Location

MATERIALS:

Aluminium, Polycarbonate

FEATURES:

- 4 sizes to choose from
- 3 color finishes (black, white, silver), can be customized.
- 3.3" Fixture Thickness (Pendant), 3.4" Fixture Thickness (Surface)
- Operation Voltage: AC120-277V;
- 0-10v dimming and non-dimmable options
- Efficiency: >105lm/w
- PMMA, UL-94VO, Anti-UV lens
- Samsung 2835, 3V, 150mA
- CCT: 2700K, 3000K, 3500K, 4000K and 5000K with a great color consistency (within 3-step MacAdam ellipse)

DIMENSIONS AND MODELS:

MODEL NUMBER	DIMENSION					DIMENSION CODE
	A	B	L	H	C	
LL0187S-25W	16.4"(416mm)	18.9"(480mm)	9.45"(240mm)	3.0"(75mm)	1.97"	S
LL0187S-40W	20.5"(520mm)	23.6"(600mm)	11.8"(300mm)	3.0"(75mm)	1.97"	M
LL0187S-90W	30.7"(780mm)	35.4"(900mm)	17.7"(450mm)	3.0"(75mm)	1.97"	L
LL0187S-180W	40.9"(1038mm)	47.2"(1200mm)	23.6"(600mm)	3.0"(75mm)	1.97"	XL

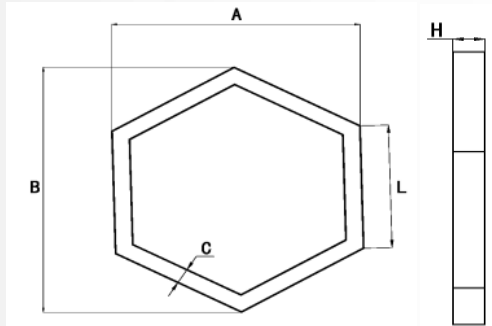

Ordering Format	Model No.	Installation	Power	CRI	CCT		Control		Body Color		Dimension (mm/inch)
		LL0187	S suspended	25W	80+	30K	3000K	STD	non-dimming	SW	matt white
		M Mounted	40W	90+	40K	4000K	DIM	0-10V dimming	SB	matt black	M
			90W		50K	5000K	DA	Dali dimming	SV	silver	L
			180W		RGBW	RGBW	SR	sensor	RAL	customized color	XL
					CT	Tunable	EM	emergency			
Order Example:	LL0187S-40W-90-30-DIM--SW-M										

LIGHT DISTRIBUTION

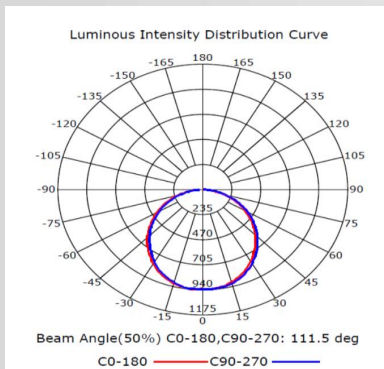

OPTICAL SYSTEM

